

PEIKER | CEE

Communication device
CEECOACH^{PLUS}

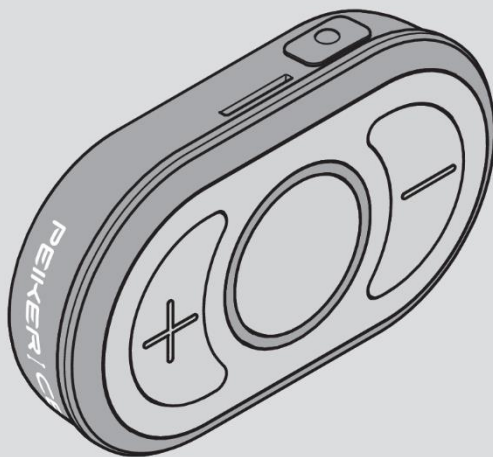

Instruction manual

English translation of the original instruction manual

12/2020

Table of contents

Notes on the manual and the manufacturer 4

Keep manual available 4

Online available information 4

Design features in the text 4

Copyright 5

Manufacturer address 5

Security..... 6

Intended use 6

Basic Safety Instructions 6

Avoid damage to property and malfunctions 7

Design features of the warning notices 8

Design features of the indications of material damage..... 8

Description 9

Scope of delivery 9

Task and function 10

Control Elements 11

Indications in the light ring 12

Unpacking and checking the scope of delivery	13
Putting the device into operation	14
Connect device to a Bluetooth® headset.....	15
Wear the device on your belt	17
Attach the device to the upper arm.....	19
Switching the device on and off	20
Switch microphone on and off (mute function).....	22
Adjust volume	23
Create group.....	24
Update the software of the device	26
Load device	27
Resetting the device to the basic setting	29
Troubleshooting.....	30
Cleaning the device	31
Store and transport the device	32
Dispose of the device	33
Technical data	34
Guarantee statements	35
EU Declaration of Conformity.....	36
FCC Note.....	37

RF Radiation Exposure Statement 38

Canada, Industry Canada (IC) Notices 39

Notes on the manual and the manufacturer

This manual will help you to use the CEECOACH ^{PLUS} communication device, version 01.00.xx or higher, safely.

The CEECOACH ^{PLUS} communication device is referred to in the following as "device".

Keep manual available

This manual is part of the device.

- ▶ Make sure that this manual is always available for you.
- ▶ Always download the latest manual after an update.

Online available information

Information about new features and updates for the device can be found in the newsletter and in social media as well as at www.peiker-cee.de.

Design features in the text

normal text

- Enumeration
- ▶ Action steps

 Tips contain additional information.

Copyright

This manual contains information that is subject to copyright. This manual may not be copied, printed, filmed, processed, duplicated or distributed in any form, either in whole or in part, without the prior written consent of peiker CEE GmbH.

©2020 peiker CEE GmbH

All rights reserved.

Manufacturer address

peiker CEE GmbH

Gartenstraße 25

D-61352 Bad Homburg

Phone: +49-6172-1797-500

E-mail: info@peiker-cee.de

Internet: www.peiker-cee.de

Security

Intended use

The device is used for group communication in the sports and leisure sector. The device can communicate with a maximum of 16 participants in a conference.

The range between the participants is up to 700 m.

The distance between the devices must be less than 10 m when connecting to a group.

Reading and understanding this manual is also part of the intended use.

Furthermore, you must observe and follow all information in this manual, especially the safety instructions.

Any other use is expressly deemed to be improper.

Basic Safety Instructions

Avoid serious injury or death from explosions

The device has no approval according to the ATEX directive for use in potentially explosive atmospheres.

- Only use the device in areas where there are no special requirements for explosion protection.

Avoid danger of suffocation

Small parts are included in the delivery. Children can swallow the small parts while playing and choke on them.

- Make sure that the small parts do not get into the hands of children.

Avoid hearing damage

Too high volume levels can irreparably damage your hearing.

- ▶ Avoid continuous exposure to sound at maximum volume.

Avoid environmental damage

- ▶ Dispose of the device and its components in accordance with the regulations applicable at the place of use.

Avoid damage to property and malfunctions**Avoid damage to the device due to incorrect use**

- ▶ Attach the device to your belt or wear it securely on your upper arm. A belt clip or a wristband with velcro fastener are included.
- ▶ Do not drop the device.
- ▶ Avoid shock loads.

Avoid headset cable break

- ▶ Only touch the cable at the plug for insertion or removal.

Avoid damage to the device due to incorrect cleaning





Cleaning with harsh cleaning agents can damage the device.

- ▶ Only use a soft cloth to clean the device when it is slightly dirty.
- ▶ Use only gentle cleaning agents for heavy soiling. Make sure that the cleaning agent does not attack the housing parts and buttons by trying it out on a concealed area.

Avoid damage to the device due to improper repair

- ▶ Never open the housing of the device.
- ▶ Have the device repaired by qualified personnel only.

Design features of the warning notices

 WARNING	
	Notes with the word WARNING warn of a dangerous situation that could result in death or serious injury.
 CAUTION	
	Notes with the word CAUTION warn of a situation that may cause minor or moderate injury.

Design features of the indications of material damage

<i>ATTENTION!</i>	
	These notes warn of a situation that could lead to material damage and limited functionality.

Description

Scope of delivery

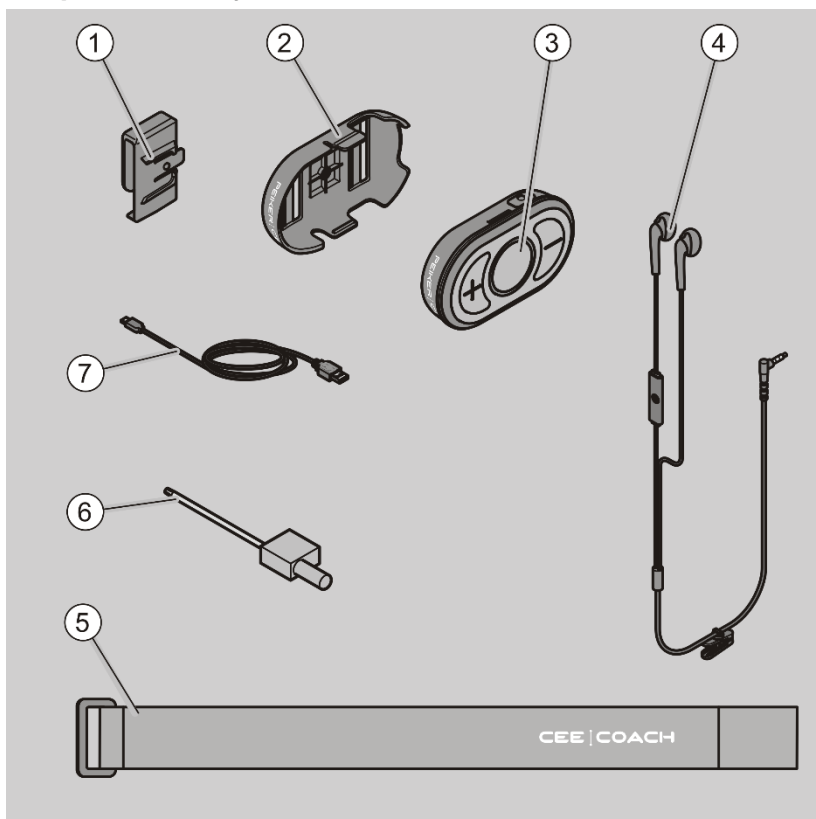

No.	Designation
1	Belt clip (included 2 times in the duo set)
2	Holder (included 2 times in the duo set)
3	Device (included 2 times in the Duo-Set)
4	Headset (included 2 times in the Duo-Set)
5	wristband with velcro (included 2 times in the duo set)
6	Screwdriver
7	USB-C cable (included 2 times in the duo set)

Task and function

The device is used for group communication in sports and leisure time.

The device can communicate with a maximum of 16 participants in a conference.

The range between the participants is up to 700 m.

The distance between the devices must be less than 10 m when connecting to a group.

Control Elements

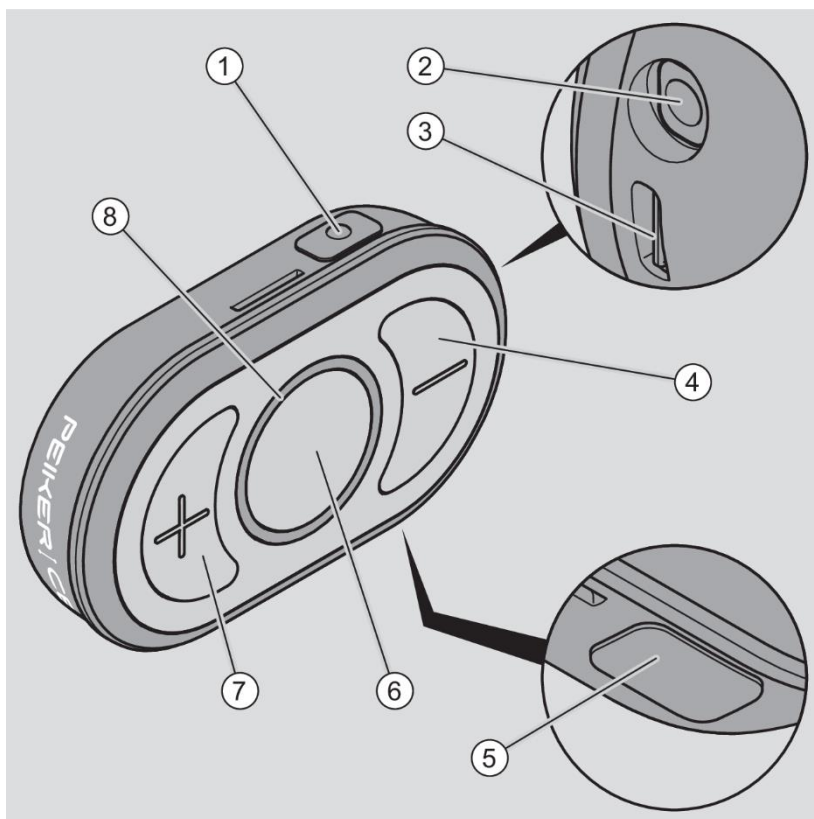



No.	Designation
1	Function key for connecting the device to other devices
2	Connection socket for headset
3	USB socket for USB-C cable
4	Minus key: decrease volume
5	Function key to connect the device to other devices or to the Bluetooth® headset
6	Main key: Switch device on and off Switch microphone on and off
7	Plus key: Increase volume
8	illuminated ring

Indications in the light ring

Color	Meaning
Red	Battery almost empty (less than 30 % charged)
Yellow	Battery charged between 30 % and 70
Green	Battery more than 70% charged Device is connected and at least one device is in the transmit and receive range
White	There is no connection to other devices
Cyan	Device is connected, but there is no other device in the transmit and receive area
Blue	Device can be connected to a Bluetooth® headset
Magenta	The microphone is switched off

Unpacking and checking the scope of delivery

 WARNING	
	<p>Small parts are included in the delivery.</p> <p>Children can swallow the small parts while playing and choke on them.</p> <ul style="list-style-type: none">▶ Make sure that the small parts do not get into the hands of children.

- ▶ Remove the parts of the device from the original packaging.
- ▶ Keep the original packaging for possible return.
- ▶ Check that all parts of the device have been supplied.
- ▶ Check that the parts are in perfect condition.
- ▶ Contact the manufacturer if parts are missing or damaged.

Putting the device into operation

- ▶ Switch on the device (see section "Switching the device on and off" on page20).
- ▶ Use the headset as described in the manual of the respective manufacturer.
- ▶ When using a Bluetooth® headset, proceed as described in section "Connecting the device to a Bluetooth® headset" on page15.
- ▶ Connect the device to the other devices you want to use.

You can connect the device with up to 15 other devices to form a group (see section "Forming a group" on page24).

- ❗ The devices in the Duo Set are connected to each other in the delivery condition.

Connect device to a Bluetooth® headset

- ▶ Switch on the device (see section "Switching the device on and off" on page 20).
- ▶ Turn on the Bluetooth® headset.
- ▶ Make sure that the Bluetooth® headset is in pairing mode. Follow the instructions in the Bluetooth® headset user guide.
- ▶ Press the function key (1) on the device.

The light ring shines blue in a circular pattern. During this time you can connect your device to a Bluetooth® headset.

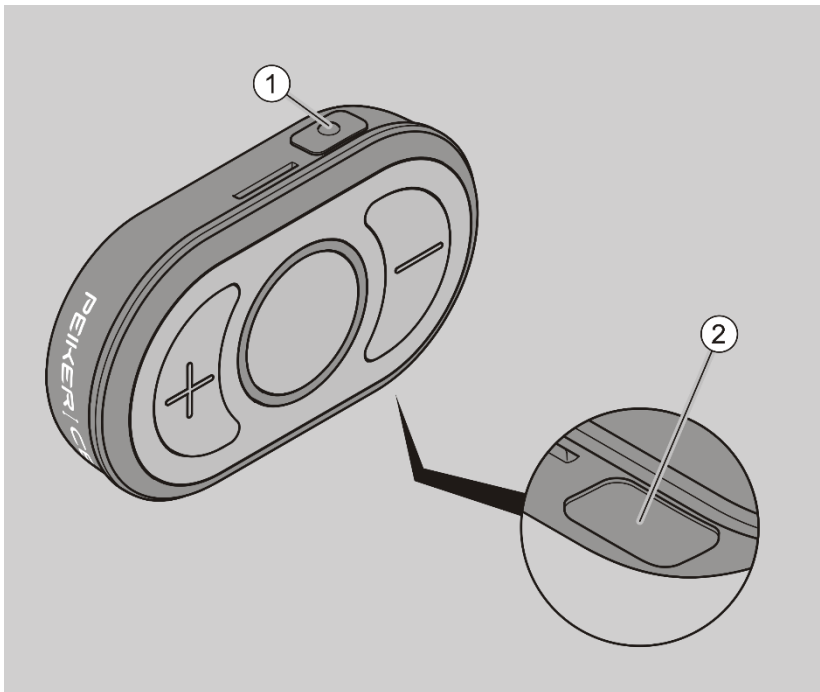

When using the device with a Bluetooth® headset, please note the following:

- When a device is connected to a Bluetooth® headset, the Bluetooth® headset and the device can be turned off. After both devices are switched on again, they will automatically connect (re-connect).
- If you want to connect the device to another Bluetooth® headset, you must turn off the currently connected Bluetooth® headset. You can connect the device with the other Bluetooth® headset as described in section "Connecting the device to a Bluetooth® headset" on page 15
- When a Bluetooth® headset is connected and a corded headset is plugged into the device, the connection is transferred to the corded headset. As soon as the plug is pulled out of the connection socket, the audio connection automatically returns to the Bluetooth® headset.

If the connection is not successful, this could be due to the following reasons:

- The Bluetooth® headset does not allow pairing.
- The battery of the Bluetooth® headset is discharged.
- ▶ Make sure that the Bluetooth® headset is in pairing mode.

With many Bluetooth® Headsets this is indicated by a blue flashing LED.

- ▶ Proceed as described in the operating instructions for the Bluetooth® headset.

Wear the device on your belt

ATTENTION!	
	<p>Damage to the device due to incorrect wearing is possible.</p> <ul style="list-style-type: none"> ▶ If possible, attach the device to the belt with the supplied belt clip or wear it securely on your upper arm. ▶ Do not drop the device. ▶ Avoid shock loads.

- ▶ Attach the holder to the device.
- ▶ Push the belt clip (1) over the holder (2) until the locking lever (5) audibly engages.
- ▶ Hook the device together with the belt clip (2.) on the belt (3).

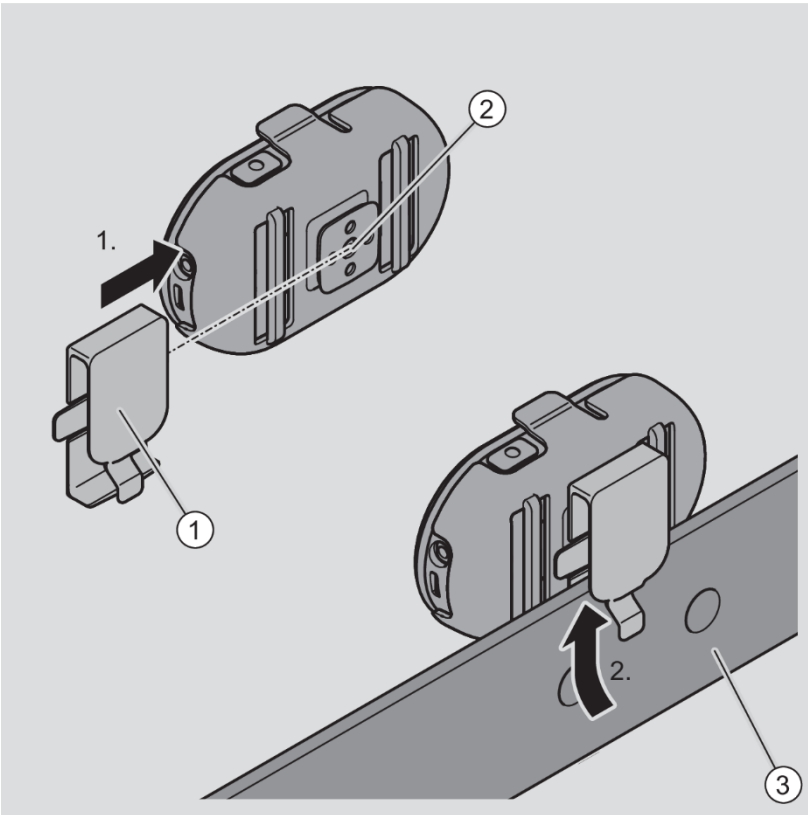

i Alternatively you can thread the belt through the belt clip.

- To remove, lift the nose of the belt clip and pull the device together with the belt clip off the belt.
- To remove the belt clip, pull the locking lever upwards and remove the belt clip from the device.

Attach the device to the upper arm

- ▶ Remove the holder (1.) on the bracket. Use the supplied screwdriver.
- ▶ Feed the bracelet (2) through the loops (1) as shown (2.) and pull it through to the end.
- ▶ To attach the device to your upper arm, pass the strap (2) through the tab.
- ▶ Put your arm through the loop and attach the device with the wrist strap (2) to your upper arm.

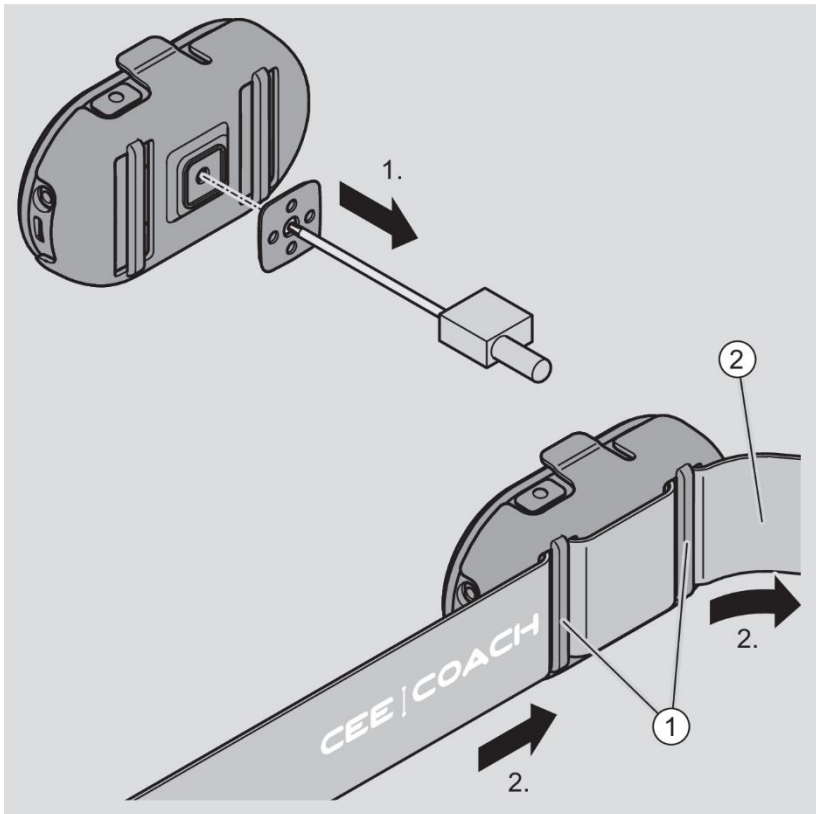

Switching the device on and off

- To switch on the device, press the main button (1) and hold it pressed for at least 3 seconds.

The light ring (2) then shows a color for 3 seconds (green, orange or red depending on the battery charge). You will also hear the voice announcement "Power on". The light ring (2) flashes 3 times in cyan or white if the device is not connected to any other device. After that the light ring (2) flashes once every 3 seconds in the color green if the device is connected with at least one other device.

- To switch off the device, press the main button (1) again and hold it down for at least 3 seconds.

The light ring (2) then shows a color for 3 seconds (green, orange or red depending on the battery charge). You will also hear the voice announcement "Power off".

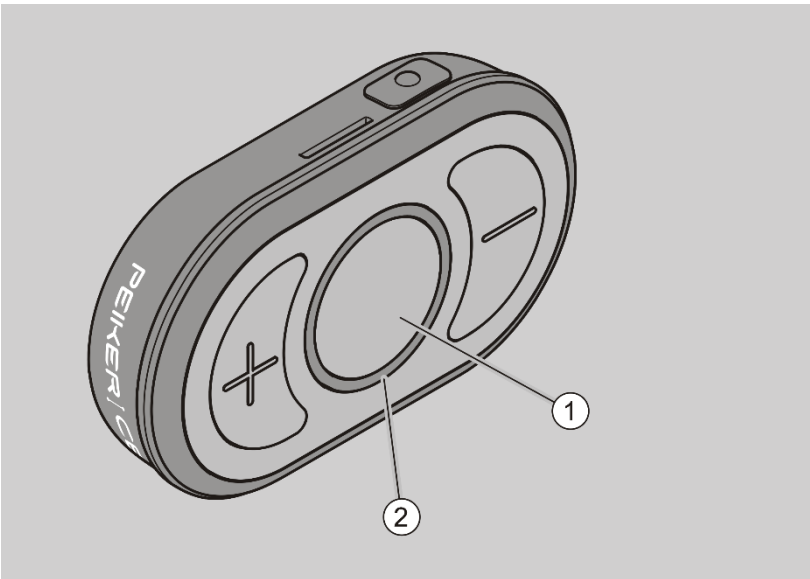

- ① The device is automatically switched off after five minutes if there is no connection to another device. This is the case when the LED is white every 2 seconds (device is not paired) or cyan (no other device is within radio range).

Switch microphone on and off (mute function)

- To switch off the microphone press the main button (1) briefly.



You listen to the voice message "Mute". The light ring (2) flashes magenta. You are now no longer heard by other connected participants.

- To switch on the microphone, press the main button (1) again briefly.

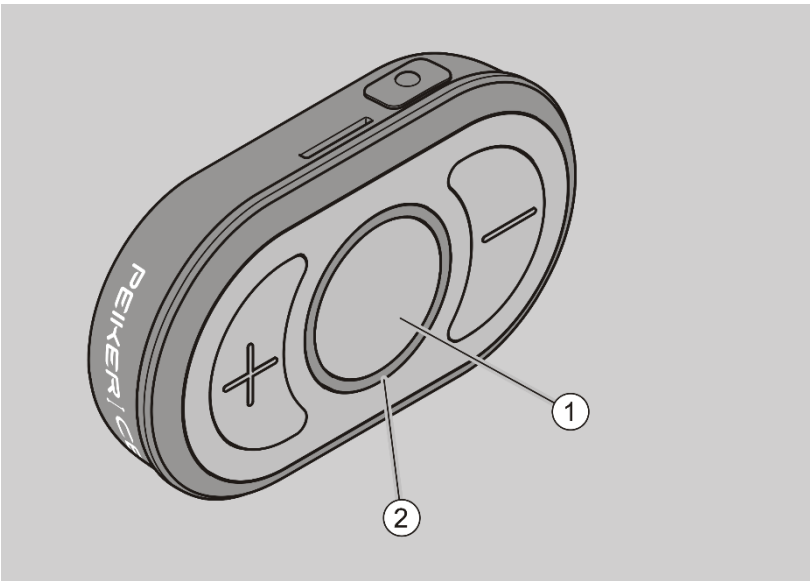
You hear the voice message "Mute off". You are now heard again by the connected participants.



Adjust volume

 CAUTION	
	<p>Hearing damage due to too loud noises possible.</p> <ul style="list-style-type: none">▶ Avoid continuous exposure to sound at maximum volume.

- ▶ To increase the volume, press the Plus key step by step.

The device becomes louder in 1/12 steps. The color display in the light ring becomes larger. At maximum volume, the light ring lights up completely green.

- ▶ To reduce the volume, press the Minus key step by step.

The device becomes quieter in 1/12 steps. The color display in the light ring becomes smaller. At minimum volume, only one LED lights up.

- ▶ To change the volume quickly, hold down the Plus or Minus key.

Create group

You can form a group with up to 15 other devices. The distance between the devices must be less than 10 m when connected.

- ▶ Make sure that the devices to be connected are within range.
- ▶ Switch the devices on (see "Switching the device on and off" on page 20).
- ▶ Press the function keys (1, 2) on the devices simultaneously for at least one second.

The light ring now fills with a color for 30 seconds and connects to all other devices that are also in this state. After that you will hear the voice message "Device is connected" if at least one other device has been successfully connected. The light ring flashes green.

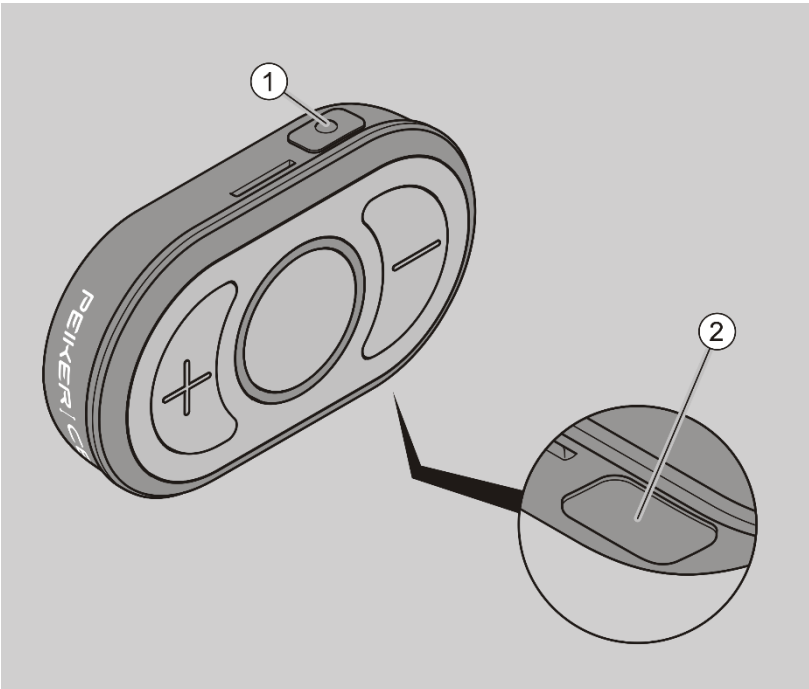

If no connection has been established, the light ring flashes white.

► In this case repeat the process.

① You can create new groups of connected devices at any time (see section "Creating groups" on page24).

Update the software of the device

An update app is available for Windows and Apple computers at www.peiker-cee.de/doc.

To download the update app you need the operating system WINDOWS 10 or MAC-OS on your computer.

Proceed as follows:

- Download the file *CeecoachplusUpdaterInstaller*.
- After the loading process is finished, start the file with a double click. The Update-App will be installed.
- Launch the app at any time. If an update is available you can download it to your device.
- You will first be asked to connect your device to your computer via the USB-C cable.

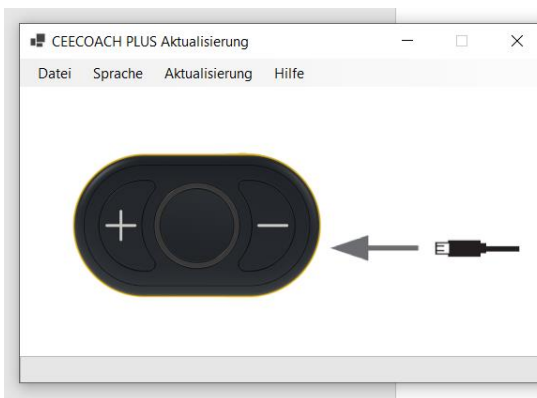

- i** If you do not have administrative rights on your computer, you will receive a corresponding message. In this case, log in as administrator or call your IT administrator to install the Update-App.

Load device

 WARNING	
	<p>Fire possible due to overheated components.</p> <p>► Never charge the battery unattended.</p>

You want to check the charge status of your device.

- Switch the device on or off.

During this process, the charging status is displayed (see section "Display in the light ring" on page12).

- Insert the smaller plug of the USB-C cable (2) into the USB-C socket (1).

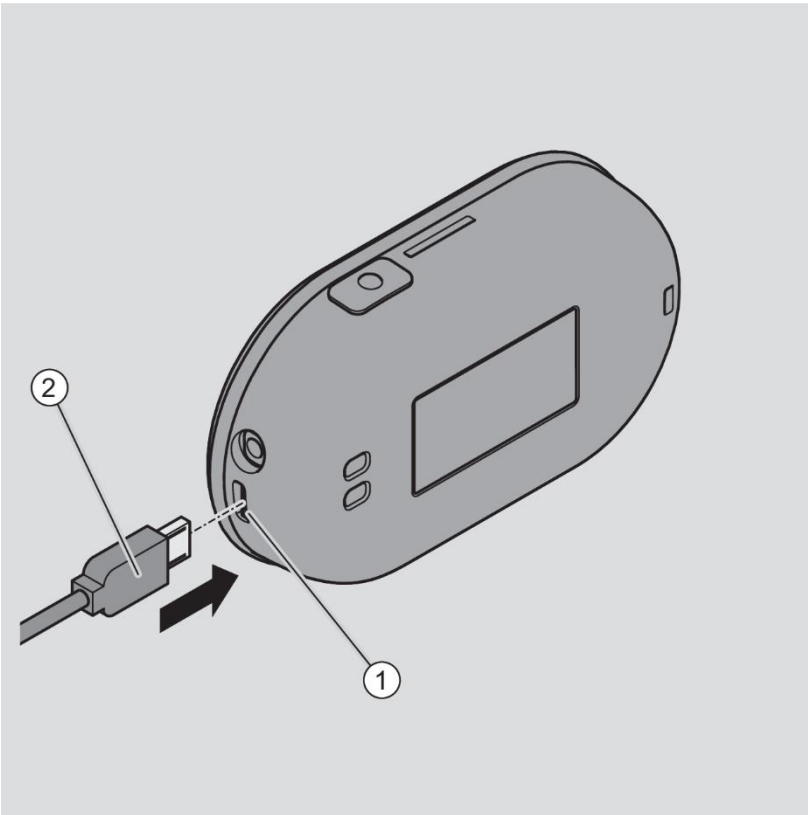

- ▶ Connect the larger plug of the USB-C cable to the charger.
- ▶ Connect the charger to a suitable power outlet.

The charging time depends on the ambient temperature and the power of the charger.

When the device's battery is fully charged, the light ring will glow solid green when the device is turned off until the device is disconnected from the charger.

Resetting the device to the basic setting

- ▶ Make sure that the device is switched on.
- ▶ Press the main key (1) and the plus and minus keys simultaneously and hold them down for more than five seconds.

The light ring (2) shines green twice, white once and then orange. The device is switched off.

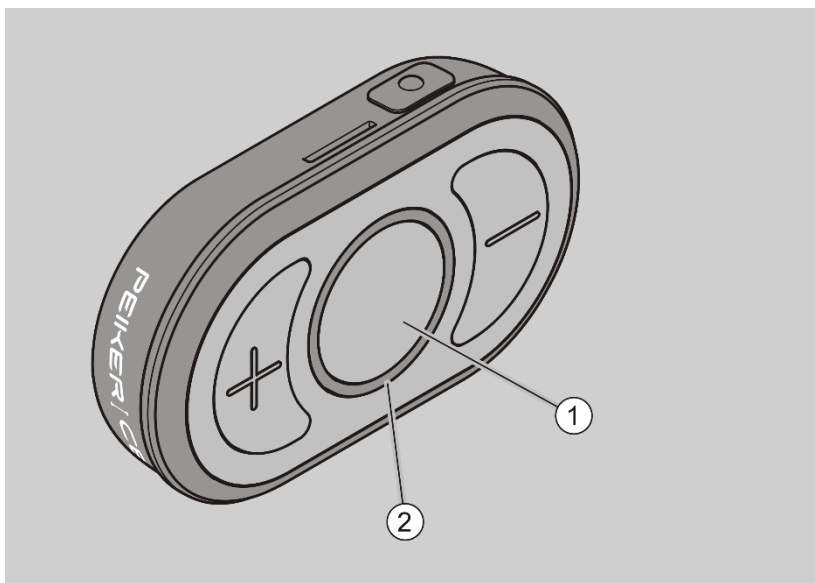

The following settings are deleted, among others:

- existing connections to the other devices
- existing connection to the Bluetooth® headset.

Troubleshooting

Problem	Possible cause	Remedy
Device cannot be connected with the other devices to form a group.	<ul style="list-style-type: none"> • The other devices are out of range. 	<ul style="list-style-type: none"> ► Make sure that the devices are within the maximum distance of 10 m.
Communication does not work.	<ul style="list-style-type: none"> • Microphone is switched off. • Participants are not in the transmission and reception area. 	<ul style="list-style-type: none"> ► Make sure that the microphone is switched on. ► Make sure that you are in the transmit and receive area.
Device cannot be paired with the Bluetooth® headset	<ul style="list-style-type: none"> • The Bluetooth® headset does not allow pairing. • The Bluetooth® headset is not charged. 	<ul style="list-style-type: none"> ► Make sure that the Bluetooth® headset allows pairing. ► Make sure the Bluetooth® headset is charged. ► Repeat the procedure in section "Connecting the device to a Bluetooth® headset" starting on page 15.

i On the peiker CEE website you will find a list of frequently asked questions (FAQ), which is constantly updated. Check there as well, if there is an answer for your problem.

Cleaning the device

ATTENTION!

Damage to the device possible by using strong cleaning agents.

- ▶ Use only mild detergents for heavy soiling.

- ▶ If necessary, clean the device and headset with a slightly moistened cloth.
- ▶ If the device is very dirty, clean it only with mild detergents, e.g. dishwashing detergent.

Store and transport the device

- ▶ Store the device and its components in a dry, dust-free place.
- ▶ For storage and transport, for example, use the optionally available transport bag.

Dispose of the device

At the end of its service life, the device and its components must be disposed of in an environmentally friendly manner.

- ▶ Dispose of the device in accordance with the regulations applicable at the place of use.
- ▶ In case of doubt, contact your city or municipal administration.

The device consists of:

- Housing made of plastic
- Electronic Components
- Batteries (Li-Ion)



Technical data

Device	
Number of participants	2–16
Headset connection	Bluetooth® headset or standard 3.5 mm jack
Mounting	Clip can be locked in 90° steps
Display	illuminated ring with 12 LEDs, multicolor
Number of keys	5
Device connection	USB-C
Charger connection	USB-A
Call time (operating time)	up to 18 hours
Charging duration/charging time	up to 3 hours
Power supply	Li-Ion battery, 2000 mAh
Ambient temperature for battery charging	+5°C to +45°C
Radio standards	Bluetooth® 4.2, HSP, HFP
Housing color	yellow/black
Key color	black
Operating temperature	-10°C to +45°C
Protection class	IP67 certification (splash-proof, dustproof, shockproof)
Dimensions (W × H × D)	97 × 57 × 22 mm
Weight	96 g
Update	via USB
Certifications	CE (Europe), FCC (USA), ISED (Canada), ACMA (Australia)

Guarantee statements

peiker CEE GmbH (peiker Consumer Electronics Evolution GmbH) grants a manufacturer's warranty of two years from the date of purchase on all parts included in the scope of delivery within the scope of legal regulations (proof of purchase receipt). Improper handling or incorrect use shall exclude liability for defects.

EU Declaration of Conformity

Hereby peiker CEE GmbH (peiker Consumer Electronics Evolution GmbH) declares that the device complies with the requirements and other relevant regulations of the directive RED 2014/53/EU.

Further information can be found at: <http://www.ceecoach.com/DoC>

FCC Note

This equipment has been tested and found to comply with the limits for a Class B digital device, pursuant to part 15 of the FCC Rules. These limits are designed to provide reasonable protection against harmful interference in a residential installation. This equipment generates, uses and can radiate radio frequency energy and, if not installed and used in accordance with the instructions, may cause harmful interference to radio communications. However, there is no guarantee that interference will not occur in a particular installation. If this equipment does cause harmful interference to radio or television reception, which can be determined by turning the equipment off and on, the user is encouraged to try to correct the interference by one or more of the following measures:

- Reorient or relocate the receiving antenna.
- Increase the separation between the equipment and receiver.
- Connect the equipment into an outlet on a circuit different from that to which the receiver is connected.
- Consult the dealer or an experienced radio / TV technician for help.

Note regarding FCC 15.21

Warning: Changes or modifications not expressly approved by peiker CEE GmbH void user's authority to operate equipment.

Note regarding FCC 15.19

This device complies with Part 15 of the FCC Rules. Operation is subject to the following two conditions:

- (1) this device may not cause harmful interference, and
- (2) this device must accept any interference received,
- (3) including interference that may cause undesired operation.

RF Radiation Exposure Statement

This equipment complies with the FCC/IC radiation exposure limits set fourth for portable transmitting devices operation in an uncontrolled environment. End users must follow the specific operating instructions to satisfy RF exposure compliance.

- This transmitter must not be co-located or operation in conjunction with any other antenna or transmitter.
- Any changes or modifications not expressly approved by the party responsible for compliance could void the user's authority to operate this equipment.

Model: CEECOACH ^{PLUS}

FCC ID: 2ANUY-CEECPLUS

Canada, Industry Canada (IC) Notices

This device complies with Industry Canada's licence-exempt RSS-102, RSS-247. Operation is subject to the following two conditions:

- (1) This device may not cause interference; and
- (2) This device must accept any interference, including interference that may cause undesired operation of the device.

L'émetteur/récepteur exempt de licence contenu dans le présent appareil est conforme aux CNR d'Innovation, Sciences et Développement économique Canada applicables aux appareils radio exempts de licence. L'exploitation est autorisée aux deux conditions suivantes :

- (1) L'appareil ne doit pas produire de brouillage;
- (2) L'appareil doit accepter tout brouillage radioélectrique subi, même si le brouillage est susceptible d'en compromettre le fonctionnement.

Model: CEECOACH ^{PLUS}

IC: 23265-CEECPLUSM/N

: CEECOACH ^{PLUS}